

# 11PzB 935

(2V935Ah/5HR)



## Specification

Voltage Per Unit	2V(single cell)
Capacity	935Ah@5hr-rate to 1.70V per cell @25°C
Weight	Approx. without electrolyte 41.2 Kg Approx. including electrolyte 52.4 Kg
High Rate Discharge Current	935 A
Operating Temperature Range	Discharge: -40°C~60°C Charge: -20°C~50°C Storage: -40°C~60°C
Optimal Operating Temperature Range	25°C ± 5°C
Maximum Charging Current	140.3 A
Cycle charged	2.65 to 2.85 VDC/unit Average at 25°C
Self Discharge	Self-discharge ratio less than 5% per month at 25°C. Please charge batteries before using.
Terminal	D2(M10 Copper Terminals) & D4(Lead Terminals)
Dimensions (L×W×H×TH)	189mm×158mm×567mm×597mm(Total High)

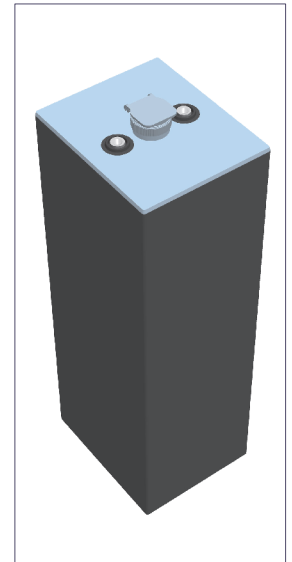

### Constant Current Discharge Characteristics : A(25°C)

F.V/Time	30MIN	1HR	2HR	3HR	4HR	5HR	6HR	8HR	10HR
1.60V	885.8	620.2	359.3	269.1	219.5	196.9	170.6	132.9	109.8
1.65V	865.4	606.0	351.1	262.9	214.5	192.4	166.7	129.9	107.3
1.70V	841.2	589.1	341.3	255.6	208.5	187.0	162.1	126.2	104.3
1.75V	809.1	566.4	328.1	245.7	200.5	179.8	155.8	121.4	100.2
1.80V	772.4	540.9	313.4	234.7	191.5	171.7	148.8	115.9	95.7
1.85V	731.7	512.6	297.0	222.4	181.4	162.7	141.0	109.8	90.7

### Constant Power Discharge Characteristics : W(25°C)

F.V/Time	30MIN	1HR	2HR	3HR	4HR	5HR	6HR	8HR	10HR
1.60V	1656.5	1194.4	705.9	533.7	436.1	391.5	339.4	264.5	218.6
1.65V	1626.8	1169.8	691.3	523.7	427.6	383.8	332.7	259.3	214.3
1.70V	1599.6	1138.8	673.0	510.7	416.7	374.0	324.1	252.5	208.5
1.75V	1539.6	1095.4	647.3	491.1	400.6	359.6	311.7	242.7	200.5
1.80V	1471.4	1051.6	621.5	469.0	382.9	343.4	297.6	231.8	191.5
1.85V	1402.2	1004.1	593.4	444.8	362.9	325.5	282.1	219.7	181.4

### Life characteristics of cyclic use

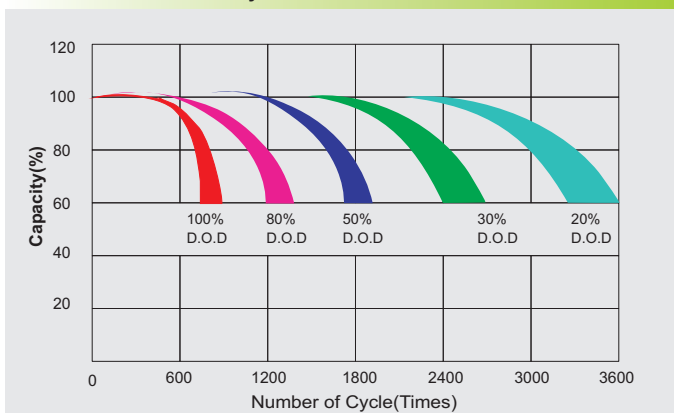

### Charge characteristic Curve for cycle use

