

# 11PzB 1100

(2V1100Ah/5HR)



## Specification

Voltage Per Unit	2V(single cell)
Capacity	1100Ah@5hr-rate to 1.70V per cell @25°C
Weight	Approx. without electrolyte 42.5 Kg Approx. including electrolyte 55.7 Kg
High Rate Discharge Current	1100 A
Operating Temperature Range	Discharge: -40°C~60°C Charge: -20°C~50°C Storage: -40°C~60°C
Optimal Operating Temperature Range	25°C ± 5°C
Maximum Charging Current	165.0 A
Cycle charged	2.65 to 2.85 VDC/unit Average at 25°C
Self Discharge	Self-discharge ratio less than 5% per month at 25°C. Please charge batteries before using.
Terminal	D2(M10 Copper Terminals) & D4(Lead Terminals)
Dimensions (L×W×H×TH)	189mm×158mm×683mm×713mm(Total High)

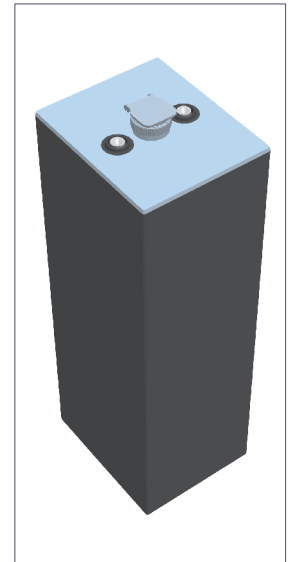

### Constant Current Discharge Characteristics : A(25°C)

F.V/Time	30MIN	1HR	2HR	3HR	4HR	5HR	6HR	8HR	10HR
1.60V	1042.1	729.6	422.7	316.6	258.3	231.6	200.8	156.4	129.1
1.65V	1018.1	713.0	413.1	309.3	252.4	226.3	196.2	152.8	126.2
1.70V	989.6	693.0	401.5	300.7	245.3	220.0	190.7	148.5	122.7
1.75V	951.9	666.3	386.1	289.1	235.9	211.5	183.3	142.8	117.9
1.80V	908.7	636.4	368.7	276.1	225.3	202.0	175.1	136.4	112.6
1.85V	860.9	603.0	349.4	261.6	213.5	191.4	165.9	129.2	106.7

### Constant Power Discharge Characteristics : W(25°C)

F.V/Time	30MIN	1HR	2HR	3HR	4HR	5HR	6HR	8HR	10HR
1.60V	1948.9	1405.2	830.4	627.8	513.1	460.6	399.3	311.1	257.2
1.65V	1913.9	1376.2	813.3	616.1	503.1	451.6	391.4	305.1	252.2
1.70V	1881.9	1339.7	791.7	600.8	490.2	440.0	381.3	297.0	245.3
1.75V	1811.3	1288.7	761.5	577.7	471.3	423.1	366.7	285.6	235.9
1.80V	1731.1	1237.2	731.1	551.7	450.5	404.0	350.2	272.7	225.3
1.85V	1649.7	1181.3	698.1	523.3	426.9	382.9	331.8	258.4	213.5

### Life characteristics of cyclic use

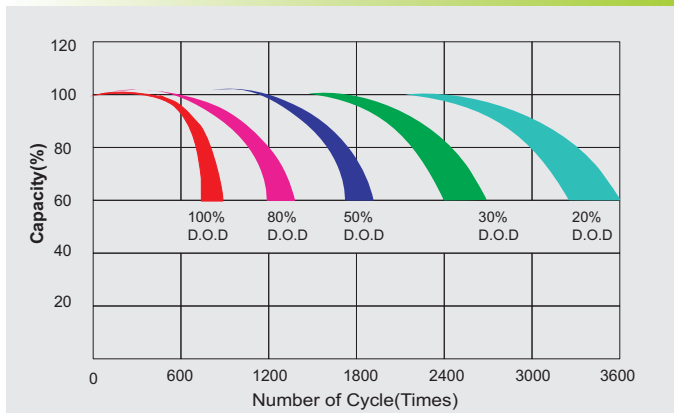

### Charge characteristic Curve for cycle use

