

# 11PzB 1155

(2V1155Ah/5HR)



## Specification

Voltage Per Unit	2V(single cell)
Capacity	1155Ah@5hr-rate to 1.70V per cell @25°C
Weight	Approx. without electrolyte 47.6 Kg Approx. including electrolyte 61.4 Kg
High Rate Discharge Current	1155 A
Operating Temperature Range	Discharge: -40°C~60°C Charge: -20°C~50°C Storage: -40°C~60°C
Optimal Operating Temperature Range	25°C ± 5°C
Maximum Charging Current	173.3 A
Cycle charged	2.65 to 2.85 VDC/unit Average at 25°C
Self Discharge	Self-discharge ratio less than 5% per month at 25°C. Please charge batteries before using.
Terminal	D2(M10 Copper Terminals) & D4(Lead Terminals)
Dimensions (L×W×H×TH)	189mm×158mm×683mm×713mm(Total High)

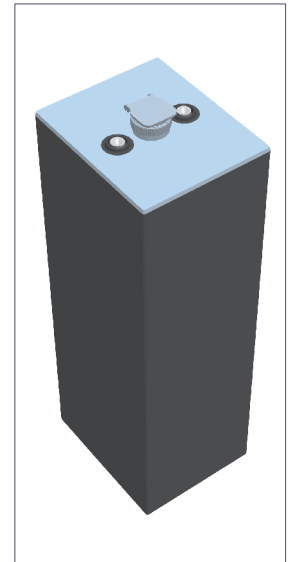

### Constant Current Discharge Characteristics : A(25°C)

F.V/Time	30MIN	1HR	2HR	3HR	4HR	5HR	6HR	8HR	10HR
1.60V	1094.2	766.1	443.9	332.4	271.2	243.2	210.8	164.2	135.6
1.65V	1069.1	748.6	433.7	324.8	265.0	237.7	206.0	160.4	132.5
1.70V	1039.1	727.7	421.6	315.7	257.6	231.0	200.2	155.9	128.8
1.75V	999.5	699.7	405.4	303.6	247.7	222.1	192.5	149.9	123.8
1.80V	954.1	668.2	387.1	289.9	236.5	212.1	183.8	143.2	118.3
1.85V	903.9	633.2	366.9	274.7	224.1	201.0	174.2	135.7	112.1

### Constant Power Discharge Characteristics : W(25°C)

F.V/Time	30MIN	1HR	2HR	3HR	4HR	5HR	6HR	8HR	10HR
1.60V	2046.3	1475.5	871.9	659.2	538.8	483.6	419.2	326.7	270.1
1.65V	2009.6	1445.0	853.9	646.9	528.2	474.1	411.0	320.3	264.8
1.70V	1976.0	1406.7	831.3	630.9	514.7	462.0	400.4	311.9	257.6
1.75V	1901.9	1353.1	799.6	606.6	494.9	444.2	385.0	299.9	247.7
1.80V	1817.6	1299.1	767.7	579.3	473.0	424.2	367.7	286.4	236.5
1.85V	1732.2	1240.4	733.0	549.4	448.3	402.0	348.4	271.4	224.1

### Life characteristics of cyclic use

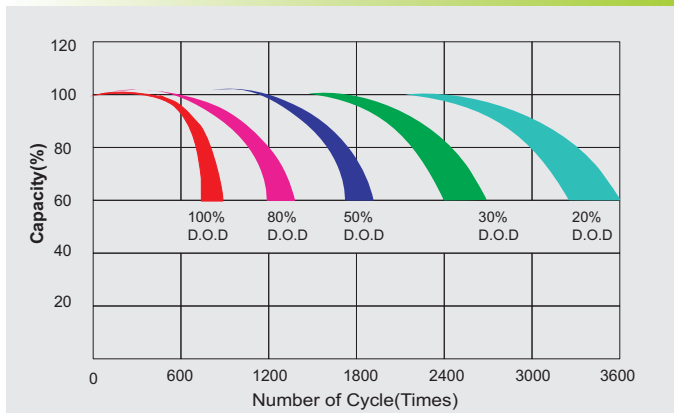

### Charge characteristic Curve for cycle use

