

12PzB 1260

(2V1260Ah/5HR)



Specification

| | |
|-------------------------------------|--|
| Voltage Per Unit | 2V(single cell) |
| Capacity | 1260Ah@5hr-rate to 1.70V per cell @25°C |
| Weight | Approx. without electrolyte 51.5 Kg Approx. including electrolyte 66.6 Kg |
| High Rate Discharge Current | 1260 A |
| Operating Temperature Range | Discharge: -40°C~60°C Charge: -20°C~50°C Storage: -40°C~60°C |
| Optimal Operating Temperature Range | 25°C ± 5°C |
| Maximum Charging Current | 189.0 A |
| Cycle charged | 2.65 to 2.85 VDC/unit Average at 25°C |
| Self Discharge | Self-discharge ratio less than 5% per month at 25°C. Please charge batteries before using. |
| Terminal | D2(M10 Copper Terminals) & D4(Lead Terminals) |
| Dimensions (L×W×H×TH) | 205mm×158mm×683mm×713mm(Total High) |

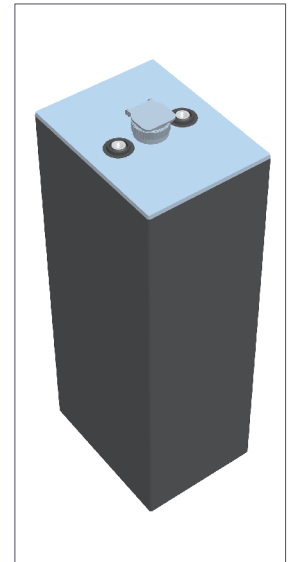

Constant Current Discharge Characteristics : A(25°C)

| F.V/Time | 30MIN | 1HR | 2HR | 3HR | 4HR | 5HR | 6HR | 8HR | 10HR |
|----------|--------|-------|-------|-------|-------|-------|-------|-------|-------|
| 1.60V | 1193.6 | 835.8 | 484.2 | 362.6 | 295.8 | 265.3 | 230.0 | 179.1 | 147.9 |
| 1.65V | 1166.2 | 816.7 | 473.2 | 354.3 | 289.1 | 259.3 | 224.7 | 175.0 | 144.5 |
| 1.70V | 1133.6 | 793.8 | 459.9 | 344.4 | 281.0 | 252.0 | 218.4 | 170.1 | 140.5 |
| 1.75V | 1090.4 | 763.3 | 442.2 | 331.2 | 270.2 | 242.3 | 210.0 | 163.6 | 135.1 |
| 1.80V | 1040.9 | 728.9 | 422.3 | 316.3 | 258.0 | 231.4 | 200.6 | 156.2 | 129.0 |
| 1.85V | 986.1 | 690.8 | 400.2 | 299.7 | 244.5 | 219.3 | 190.1 | 148.0 | 122.3 |

Constant Power Discharge Characteristics : W(25°C)

| F.V/Time | 30MIN | 1HR | 2HR | 3HR | 4HR | 5HR | 6HR | 8HR | 10HR |
|----------|--------|--------|-------|-------|-------|-------|-------|-------|-------|
| 1.60V | 2232.3 | 1609.6 | 951.2 | 719.2 | 587.7 | 527.5 | 457.3 | 356.4 | 294.6 |
| 1.65V | 2192.3 | 1576.4 | 931.6 | 705.7 | 576.2 | 517.2 | 448.4 | 349.4 | 288.8 |
| 1.70V | 2155.6 | 1534.6 | 906.9 | 688.2 | 561.5 | 504.0 | 436.8 | 340.2 | 281.0 |
| 1.75V | 2074.8 | 1476.2 | 872.3 | 661.7 | 539.9 | 484.6 | 420.0 | 327.1 | 270.2 |
| 1.80V | 1982.9 | 1417.2 | 837.5 | 632.0 | 516.0 | 462.8 | 401.1 | 312.4 | 258.0 |
| 1.85V | 1889.6 | 1353.1 | 799.6 | 599.4 | 489.0 | 438.6 | 380.1 | 296.0 | 244.5 |

Life characteristics of cyclic use

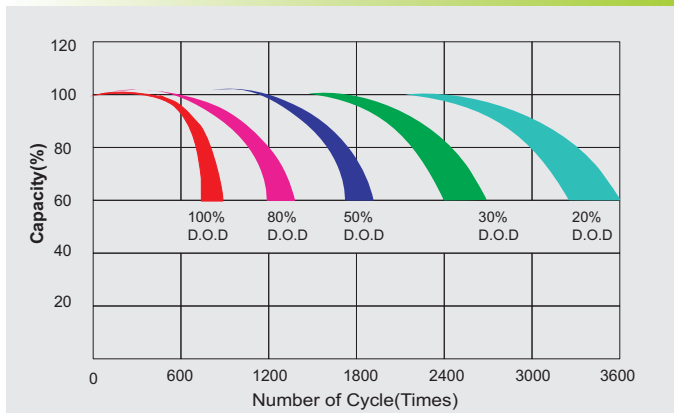

Charge characteristic Curve for cycle use

