

3PzS 270

(2V270Ah/5HR)



Specification

Voltage Per Unit	2V(single cell)
Capacity	270Ah@5hr-rate to 1.70V per cell @25°C
Weight	Approx. without electrolyte 13.0 Kg Approx. including electrolyte 16.2 Kg
High Rate Discharge Current	270 A
Operating Temperature Range	Discharge: -40°C~60°C Charge: -20°C~50°C Storage: -40°C~60°C
Optimal Operating Temperature Range	25°C ± 5°C
Maximum Charging Current	40.5 A
Cycle charged	2.65 to 2.85 VDC/unit Average at 25°C
Self Discharge	Self-discharge ratio less than 5% per month at 25°C. Please charge batteries before using.
Terminal	D2(M10 Copper Terminals) & D4(Lead Terminals)
Dimensions (L×W×H×TH)	65mm×198mm×475mm×505mm(Total High)

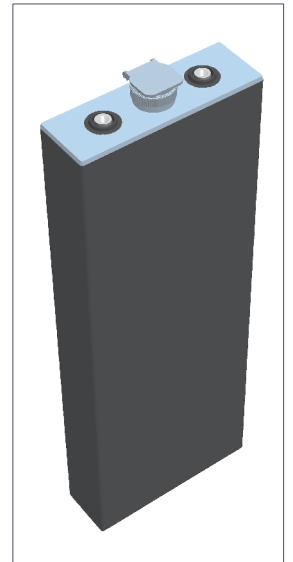

Constant Current Discharge Characteristics : A(25 °C)

F.V/Time	30MIN	1HR	2HR	3HR	4HR	5HR	6HR	8HR	10HR
1.60V	255.8	179.1	103.8	77.7	63.4	56.9	49.3	38.4	31.7
1.65V	249.9	175.0	101.4	75.9	61.9	55.6	48.2	37.5	31.0
1.70V	242.9	170.1	98.6	73.8	60.2	54.0	46.8	36.5	30.1
1.75V	233.7	163.6	94.8	71.0	57.9	51.9	45.0	35.0	28.9
1.80V	223.0	156.2	90.5	67.8	55.3	49.6	43.0	33.5	27.6
1.85V	211.3	148.0	85.8	64.2	52.4	47.0	40.7	31.7	26.2

Constant Power Discharge Characteristics : W(25 °C)

F.V/Time	30MIN	1HR	2HR	3HR	4HR	5HR	6HR	8HR	10HR
1.60V	478.4	344.9	203.8	154.1	125.9	113.0	98.0	76.4	63.1
1.65V	469.8	337.8	199.6	151.2	123.5	110.8	96.1	74.9	61.9
1.70V	461.9	328.8	194.3	147.5	120.3	108.0	93.6	72.9	60.2
1.75V	444.6	316.3	186.9	141.8	115.7	103.8	90.0	70.1	57.9
1.80V	424.9	303.7	179.5	135.4	110.6	99.2	86.0	66.9	55.3
1.85V	404.9	290.0	171.4	128.4	104.8	94.0	81.5	63.4	52.4

Life characteristics of cyclic use

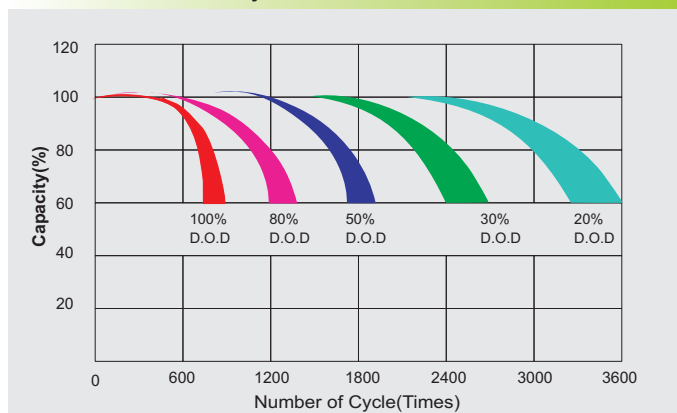

Charge characteristic Curve for cycle use

