

3PzS 315

(2V315Ah/5HR)



Specification

Voltage Per Unit	2V(single cell)
Capacity	315Ah@5hr-rate to 1.70V per cell @25°C
Weight	Approx. without electrolyte 15.0 Kg Approx. including electrolyte 18.8 Kg
High Rate Discharge Current	315 A
Operating Temperature Range	Discharge: -40°C~60°C Charge: -20°C~50°C Storage: -40°C~60°C
Optimal Operating Temperature Range	25°C ± 5°C
Maximum Charging Current	47.3 A
Cycle charged	2.65 to 2.85 VDC/unit Average at 25°C
Self Discharge	Self-discharge ratio less than 5% per month at 25°C. Please charge batteries before using.
Terminal	D2(M10 Copper Terminals) & D4(Lead Terminals)
Dimensions (L×W×H×TH)	65mm×198mm×504mm×534mm(Total High)

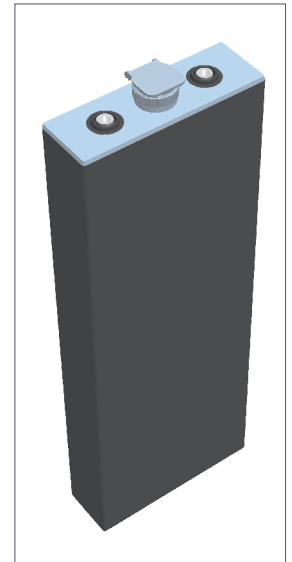

Constant Current Discharge Characteristics : A(25°C)

F.V/Time	30MIN	1HR	2HR	3HR	4HR	5HR	6HR	8HR	10HR
1.60V	298.4	208.9	121.1	90.7	74.0	66.3	57.5	44.8	37.0
1.65V	291.6	204.2	118.3	88.6	72.3	64.8	56.2	43.8	36.1
1.70V	283.4	198.5	115.0	86.1	70.2	63.0	54.6	42.5	35.1
1.75V	272.6	190.8	110.6	82.8	67.5	60.6	52.5	40.9	33.8
1.80V	260.2	182.2	105.6	79.1	64.5	57.9	50.1	39.0	32.3
1.85V	246.5	172.7	100.1	74.9	61.1	54.8	47.5	37.0	30.6

Constant Power Discharge Characteristics : W(25°C)

F.V/Time	30MIN	1HR	2HR	3HR	4HR	5HR	6HR	8HR	10HR
1.60V	558.1	402.4	237.8	179.8	146.9	131.9	114.3	89.1	73.7
1.65V	548.1	394.1	232.9	176.4	144.1	129.3	112.1	87.4	72.2
1.70V	538.9	383.6	226.7	172.1	140.4	126.0	109.2	85.1	70.2
1.75V	518.7	369.0	218.1	165.4	135.0	121.2	105.0	81.8	67.5
1.80V	495.7	354.3	209.4	158.0	129.0	115.7	100.3	78.1	64.5
1.85V	472.4	338.3	199.9	149.8	122.3	109.6	95.0	74.0	61.1

Life characteristics of cyclic use

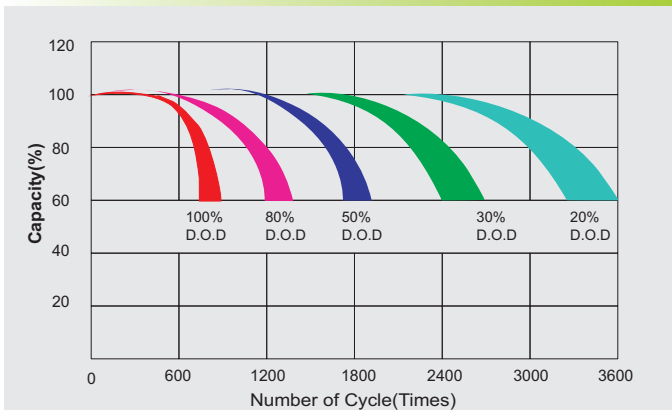

Charge characteristic Curve for cycle use

