

# 3PzS 420

(2V420Ah/5HR)



## Specification

Voltage Per Unit	2V(single cell)
Capacity	420Ah@5hr-rate to 1.70V per cell @25°C
Weight	Approx. without electrolyte 20.1 Kg Approx. including electrolyte 25.0 Kg
High Rate Discharge Current	420 A
Operating Temperature Range	Discharge: -40°C~60°C Charge: -20°C~50°C Storage: -40°C~60°C
Optimal Operating Temperature Range	25°C ± 5°C
Maximum Charging Current	63.0 A
Cycle charged	2.65 to 2.85 VDC/unit Average at 25°C
Self Discharge	Self-discharge ratio less than 5% per month at 25°C. Please charge batteries before using.
Terminal	D2(M10 Copper Terminals) & D4(Lead Terminals)
Dimensions (L×W×H×TH)	65mm×198mm×685mm×715mm(Total High)

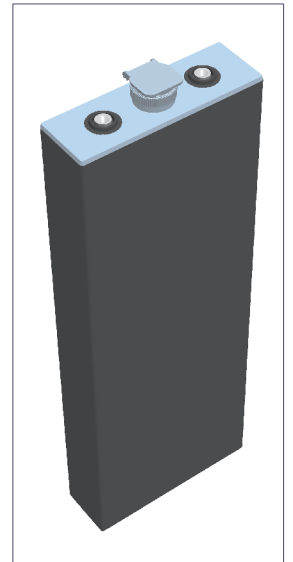

### Constant Current Discharge Characteristics : A(25 °C)

F.V/Time	30MIN	1HR	2HR	3HR	4HR	5HR	6HR	8HR	10HR
1.60V	397.9	278.6	161.4	120.9	98.6	88.4	76.7	59.7	49.3
1.65V	388.7	272.2	157.7	118.1	96.4	86.4	74.9	58.3	48.2
1.70V	377.9	264.6	153.3	114.8	93.7	84.0	72.8	56.7	46.8
1.75V	363.5	254.4	147.4	110.4	90.1	80.8	70.0	54.5	45.0
1.80V	347.0	243.0	140.8	105.4	86.0	77.1	66.9	52.1	43.0
1.85V	328.7	230.3	133.4	99.9	81.5	73.1	63.4	49.3	40.8

### Constant Power Discharge Characteristics : W(25 °C)

F.V/Time	30MIN	1HR	2HR	3HR	4HR	5HR	6HR	8HR	10HR
1.60V	744.1	536.5	317.1	239.7	195.9	175.8	152.4	118.8	98.2
1.65V	730.8	525.5	310.5	235.2	192.1	172.4	149.5	116.5	96.3
1.70V	718.5	511.5	302.3	229.4	187.2	168.0	145.6	113.4	93.7
1.75V	691.6	492.1	290.8	220.6	180.0	161.5	140.0	109.0	90.1
1.80V	661.0	472.4	279.2	210.7	172.0	154.3	133.7	104.1	86.0
1.85V	629.9	451.0	266.5	199.8	163.0	146.2	126.7	98.7	81.5

### Life characteristics of cyclic use

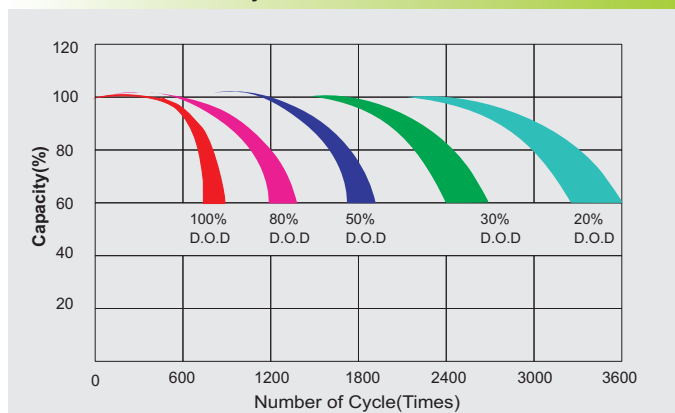

### Charge characteristic Curve for cycle use

